

Size 22 Contacts – Crimp Style

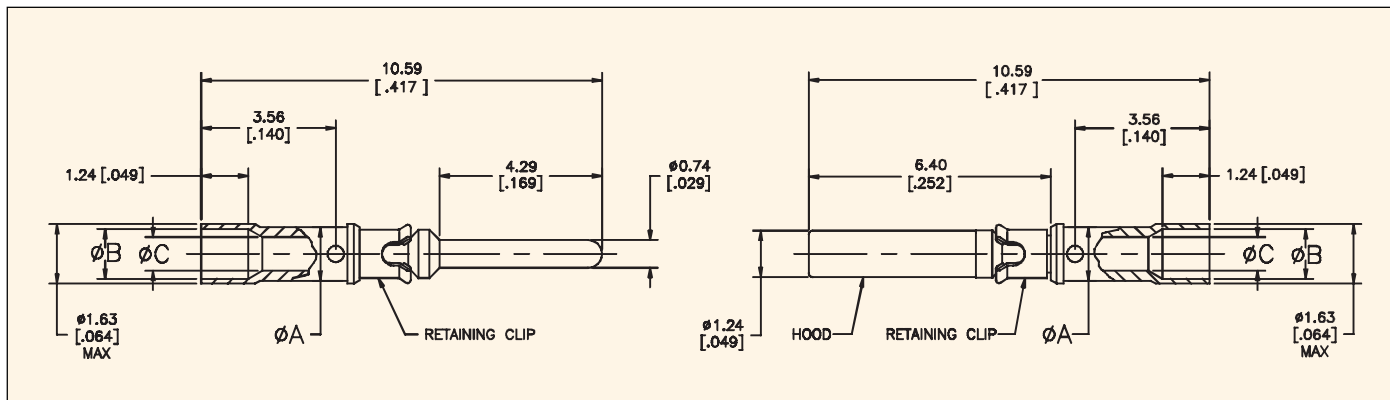

Ordering Nomenclature

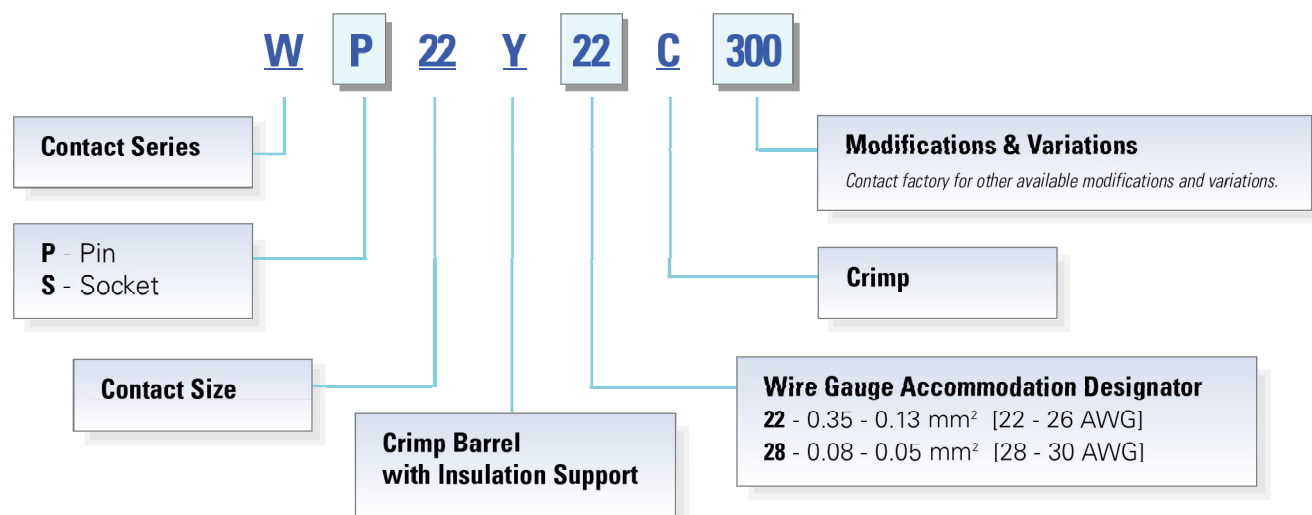

Crimp/Removable Contacts

Snap-in contacts feature a unique retaining clip for reliability and ease of maintenance for serviceability. The styles shown meet most material and finish requirements. Additional mechanical versions and plating materials are available. Contact the factory for further information.

Dimension Table

Wire Gauge Range	ØA ±0.08 [.003]	ØB ±0.08 [.003]	ØC ±0.08 [.003]
0.35 - 0.13 mm ² [22 - 26 AWG]	1.42 [.056]	1.32 [.052]	0.89 [.035]
0.08 - 0.05 mm ² [28 - 30 AWG]	0.99 [.039]	1.19 [.047]	0.48 [.019]

Materials and Finishes

Description	Material	Finish
Body	Copper Alloy	Gold Plate
Clip	Copper Alloy	Electroless Nickel, Gold Plate or None
Hood	Stainless Steel	Passivated

Dimensions shown are for reference only. Unless otherwise specified, dimensions are in millimeters and [inches].