





KM Series Subminiature Detect Switches

SWITCH FUNCTION

| NO. POLES | MODEL NO. | SWITCH FUNCTION | | CONNECTED TERMINALS | | SCHEMATIC |
|--|-----------|---|---|---|--|---|
| | | POS. 1 | POS. 2 | POS. 1 | POS. 2 | |
| | |  |  |  |  | |
| SP | KM12 | ON | MOM. | 2-1 | 4-3 |  SPDT |
| <div>SPDT</div>  <div>Part number shown: KM1202A08BE</div> | | | | | | |

ACTUATOR

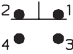
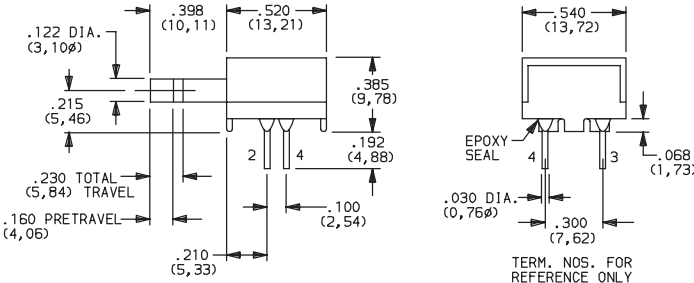
02 .398" HIGH, .122" DIA.

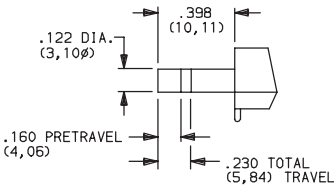

NOTE: Caps available for plunger options, see page F-39.

BUSHING/ MOUNTING STYLE

A RIGHT ANGLE

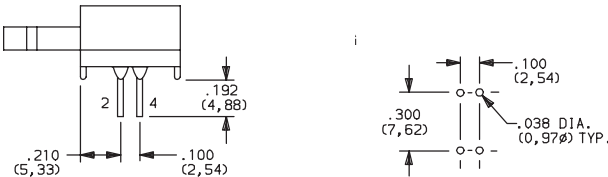

TERMINATIONS

08 RIGHT ANGLE, PC THRU-HOLE

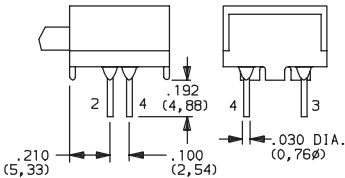

Dimensions are shown: inches (mm)
 Specifications and dimensions subject to change

KM Series

Subminiature Detect Switches

CONTACT MATERIAL

| OPTION CODE | RoHS COMPLIANT * | RoHS COMPATIBLE * | CONTACT AND TERMINAL MATERIAL | RATINGS | |
|-------------|------------------|-------------------|-------------------------------|-----------------------|---|
| B | YES | YES | GOLD ¹ | LOW LEVEL/DRY CIRCUIT | 0.4 VA MAX. @ 20 V AC OR DC MAX. |
| Q | YES | YES | SILVER ² | POWER | 0.25 AMPS @ 125 V AC OR DC (KM11, KM12) (UL) 1 AMP @ 125 V AC OR 28 V DC (KM33). |

* Note: See Technical Data section of this catalog for RoHS compliant and compatible definitions and specifications.

¹ STATIONARY CONTACTS & TERMINALS: Copper, with gold plate over nickel plate.
MOVABLE CONTACT: Phosphor bronze or beryllium copper, with gold plate over nickel plate.

² STATIONARY CONTACTS & TERMINALS: Copper, silver plated (standard with all termination options).
MOVABLE CONTACT: Phosphor bronze or beryllium copper, silver plated.

³ STATIONARY CONTACTS & TERMINALS: Copper, with gold plate over nickel plate over silver plate.
MOVABLE CONTACT: Phosphor bronze or beryllium copper, with gold plate over nickel plate over silver plate.

NOTE: Any models supplied with Q or B contact material are RoHS compliant.

KM12 models  when ordered with 'Q' contact material.

SEAL

E EPOXY SEAL

AVAILABLE HARDWARE

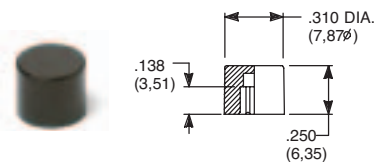

PART NO.
801801000 WHITE
801802000 BLACK
801803000 RED

Material: Nylon
 Finish: Gloss

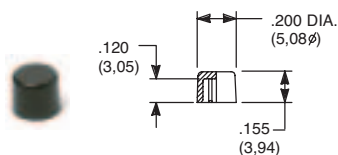

PART NO.
708901000 WHITE
708902000 BLACK
708903000 RED

Material: Nylon
 Finish: Gloss

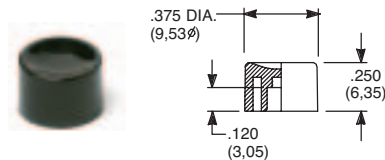

PART NO.
752701000 WHITE
752702000 BLACK
752703000 RED

Material: Nylon
 Finish: Gloss

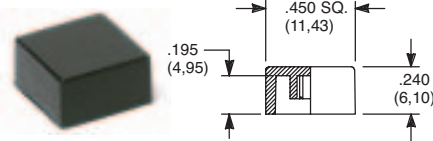

PART NO.
484601000 WHITE
484602000 BLACK
484603000 RED

PART NO.
798201000 WHITE
798202263 BLACK
798203000 RED

Material: Nylon
 Finish: Gloss

Material: Nylon
 Finish: Matte

NOTE: Other cap colors available, consult Customer Service Center.



F

Detect

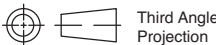

Dimensions are shown: inches (mm)
 Specifications and dimensions subject to change