

IEC appliance inlet C14, screw-on mounting, front/rear side, solder/quick connect terminal



6100-3

C14



70° C

**Description**

- Panel Mount:  
Screw-on from front or rear-side
- Appliance Inlet, Pin temperature 70 °C, Protection class I
- Solder terminals or quick connect terminals
- Alternative: protection class II version 6102-3

**Approvals**

- VDE License Number: 40015595
- UL License Number: E96454
- CSA License Number: 38456

**Other versions on request**

- Types for rivet mounting available upon request
- Types for enhanced glow wire test requirements acc. IEC 60695-2-11 to -13 for the use in unattended household equipment acc. IEC 60335-1

**Weblinks**

Approvals, RoHS, CHINA-RoHS, e-Store, SCHURTER-Stock-Check, Distributor-Stock-Check

**Technical Data**

Ratings IEC	10 A / 250VAC; 50Hz
Ratings UL/CSA	15 A / 250VAC; 60Hz
Dielectric Strength	> 2 kVAC between L-N > 2 kVAC between L/N-PE (1 min/50Hz)
Allowable Operation Temp.	-25 °C to 70 °C
Degree of Protection	from front side IP 40 acc. to IEC 60529
Protection Class	Suitable for appliances with protection class I acc. to IEC 61140
Terminal	Solder terminals or quick connect terminals
Panel Thickness s	Screw-on: max 8 mm Mounting screw torque max 0.5Nm
Material: Housing	Thermoplastic, black, UL 94V-0

Appliance-Inlet/-Outlet	C14 acc. to IEC/EN 60320-1, UL 498, CSA C22.2 no. 42 (for cold conditions) pin-temperature 70 °C, 10 A, Protection class I
-------------------------	-------------------------------------------------------------------------------------------------------------------------------

**Dimensions**

6100-3 (6102-3)

Length |-----| 48 mm

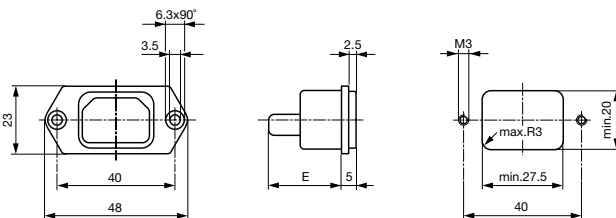

E: Solder terminals 20.5 mm

E: Quick connect terminals 23.5 mm

**Variants**

Distributor-Stock-Check | SCHURTER-Stock-Check | e-Store

Type	Protection Class	Panel mounting	Panel Thickness s [mm]	Terminal	Order Number
6100-3	I	Screw-on	-	Quick connect terminals 4.8 x 0.8 mm	6100.3200
6100-3	I	Screw-on	-	Quick connect terminals 6.3 x 0.8 mm	6100.3300
6100-3	I	Screw-on	-	Solder terminals 3.5 x 0.8 mm	6100.3100

Articles for enhanced glow wire test requirements acc. IEC 60695-2-11 to -13 can be ordered with ending ".15" (xxxx.xxxx.15). They are suitable for the use in unattended household equipment acc. IEC 60335-1.

Packaging unit 50 Pcs

## Accessory

## Description



Assorted Covers  
Rear Cover

0859.0048

4311.9401

4311.9402

4311.9404



Cord retaining kits  
Cord retaining strain relieve

Flat head, A

4700.0001

## Mating Outlets/Connectors

## Category / Description

## Appliance Outlet



IEC appliance outlet F, screw-on mounting, front side, solder /quick connect terminal

4787

IEC appliance outlet F, screw-on mounting, front side, solder /quick connect terminal

4788

IEC appliance outlet F oder H, screw-on mounting, front side, solder/PCB/quick connect terminal

5091

IEC appliance outlet F oder H, screw-on mounting, front side, solder/quick connect terminal

5092

## Connector



IEC cord connector C15, rewirable, straight

0101

IEC cord connector C15A, rewirable, straight

0102

IEC cord connector C15A, rewirable, straight

0102-G

IEC cord connector C15A, rewirable, angled

0112

IEC cord connector C13, rewirable, angled

4012

IEC cord connector C13, rewirable, angled

4013

IEC cord connector C13, rewirable, straight

4020

IEC cord connector C13, rewirable, straight

4021

IEC cord connector C13, rewirable, straight

4022

IEC cord connector C13, rewirable, angled

4300-06

...

## Power Supply or Interconnection Cord



Power Cord with IEC Appliance Connector C13, angled, 70°C

0311

Power Cord with IEC Appliance Connector C13, angled, 70°C

3011

Power Cord with IEC Appliance Connector C13, angled, 70°C

3012

Power Cord with IEC Appliance Connector C13, angled, 70°C

3013

Power Cord with IEC Appliance Connector C13, 70°C

3020

Power Cord with IEC Appliance Connector C13, straight, 70°C

3027

Power Cord with IEC Appliance Connector C13, straight, 70°C

302U

Power Cord with IEC Appliance Connector C13, straight, 70°C

3030

Power Cord with IEC Appliance Connector C13, angled, 70°C

311L

Power Cord with IEC Appliance Connector C13, angled, 70°C

312L

...