

Actual Size

LTR	REVISION	DATE	APPD
-	RELEASED	09-27-94	

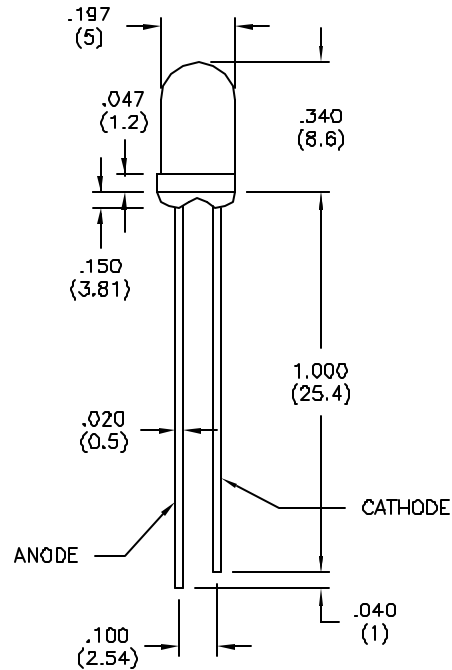
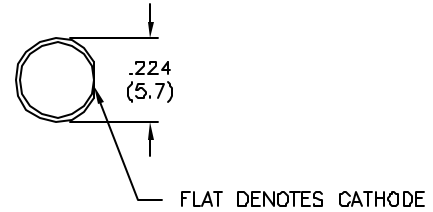
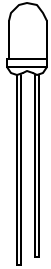

**FEATURES**

- \* STANDARD T1 3/4 SIZE
- \* PULSE RATE 2.4 Hz
- \* 1/4 DUTY CYCLE
- \* 1 INCH LEADS
- \* 1.2 mcd @ SUPPLY 3.0 VOLTAGE
- \* EASILY BE DRIVEN BY TTL & C-MOS CIRCUITS
- \* NO EXTERNAL CIRCUITRY NEEDED

**ABSOLUTE MAXIMUM**

OPERATING TEMPERATURE RANGE \_\_\_\_\_ °C ~ 70°C  
 LEAD SOLDERING TEMPERATURE  
 (1/16 INCH FROM CASE) \_\_\_\_\_ 5 SEC @ 250°C  
 OPERATING VOLTAGE \_\_\_\_\_ 15 VDC

**ELECTRIC AND RADIANT CHARACTERISTICS (T<sub>a</sub> = 25 °C)**

	MIN.	TYP.	MAX.	UNIT	TEST CONDITION
LUMINOUS INTENSITY		60.0		mcd	SUPPLY 5 VOLT
EMISSION PEAK WAVELENGTH		660		nm	
OPERATING VOLTAGE	2.0	5.0	15.0	VOLT	
BLINK FREQUENCY				Hz	SUPPLY 3 VOLT

**NOTES:**

1. ALL DIMS ARE IN INCHES (MILLIMETERS).
2. TOLERANCE IS ±.008" (±0.2mm) UNLESS OTHERWISE SPECIFIED.
3. LEAD SPACING IS MEASURED WHERE LEADS EMERGE FROM THE PACKAGE.
4. SPECIFICATIONS ARE SUBJECT TO CHANGE WITHOUT NOTICE.

**LED<sup>®</sup>**  
**LEDTRONICS, INC.**  
 23105 KASHIWA COURT  
 TORRANCE, CA 90505

-PROPRIETARY-  
 This document contains Proprietary  
 information of LEDTRONICS, INC.  
 It may not be copied, used or disclosed  
 for any purpose without the prior express  
 written consent of LEDTRONICS, Inc.  
 .XXX ± .010 TOLERANCE PER ANSI-Y14.5  
 .XX ± .025 (UNLESS OTHERWISE STATED)  
 ANGLES ± 0°.30'  
 FRACT. ± 1/32

TITLE		BKL200TR6-3V		
DWG NO	SCALE	SHEET	DATE	
DSDK0002	2:1	1 OF 1	09-27-94	
CODE IDENT NO.	DWG BY	CHK BY	QC	CUSTOMER
BZ410	JCH	PL		GENERIC