

UNLESS OTHERWISE SPECIFIED
 INCHES ± .015
 (MILLIMETERS ± 0.38)

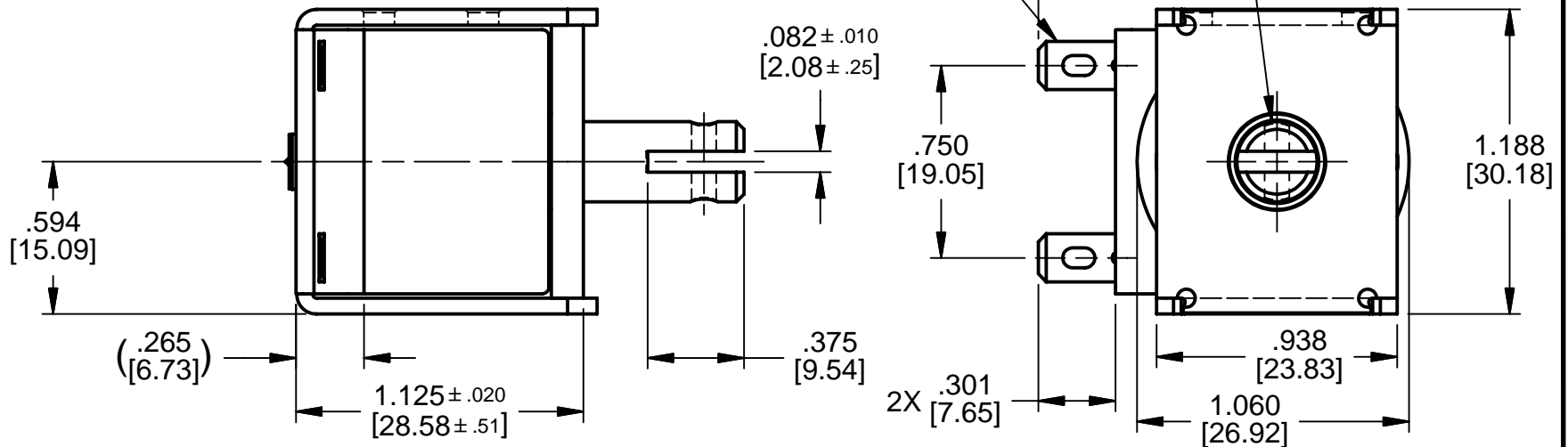

Deltrol Controls, www.deltrol-controls.com
 2740 S. 20th St. | Milwaukee, WI 53215 | Phone: 414.671.6800 Fax: 414.671.6809

| | | | | | | | | |
|------|-------------|------|----|----------------|-------------------------------------|----------|----------|--------------------------------------|
| | | | | MATERIAL | TOLERANCE (UNLESS SHOWN) | SCALE | | NAME |
| | | | | FINISH | .XXX _____ | DATE | | D-28 SOLENOID DIMENSIONAL DRAWING |
| | | | | FIRST USED ON: | .XX _____ | 05-02-06 | | |
| REV. | DESCRIPTION | DATE | BY | | DEG. _____ | DR. BY | BC | MILWAUKEE, WI. U.S.A. |
| | | | | | ◇ CRITICAL | CKD BY | | |
| | | | | | DIMENSIONS PER ANSI/ASME Y14.5-1994 | APPR. BY | I | DWG. NO. A |
| | | | | | TOOL No. | | | |
| | | | | | | | | REV. |

D-28 FORCE CURVES (CLASS A)

AC CONTINUOUS DUTY - 8VA

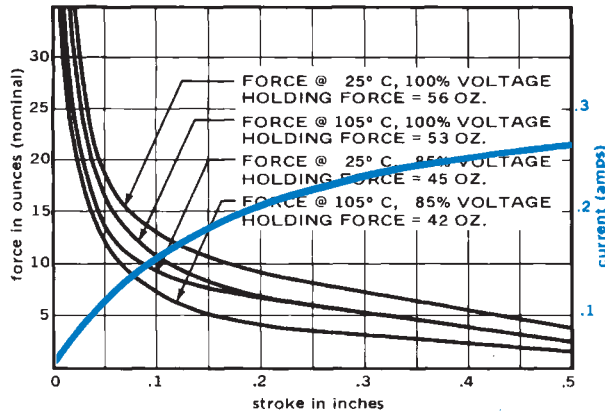

DC CONTINUOUS DUTY - 5.5 WATTS

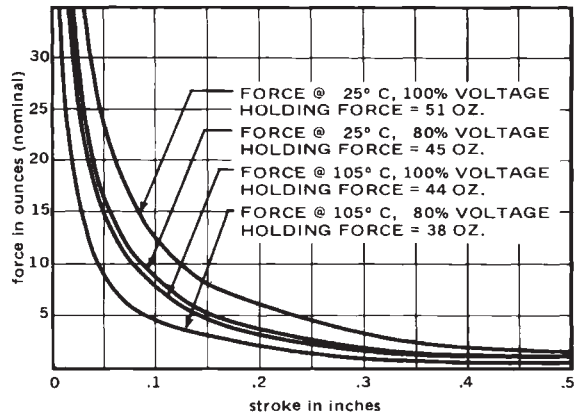

AC INTERMITTENT DUTY - 21VA

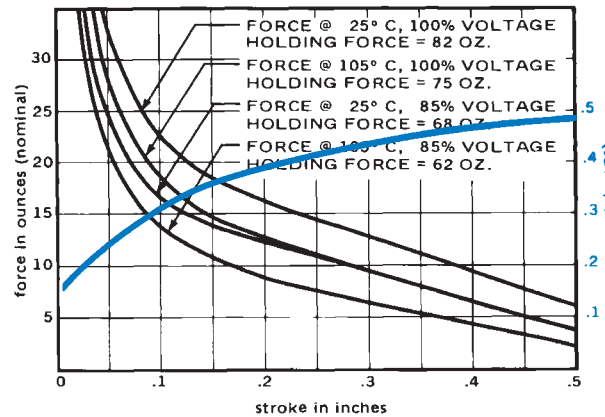

DC INTERMITTENT DUTY - 11.5 WATTS

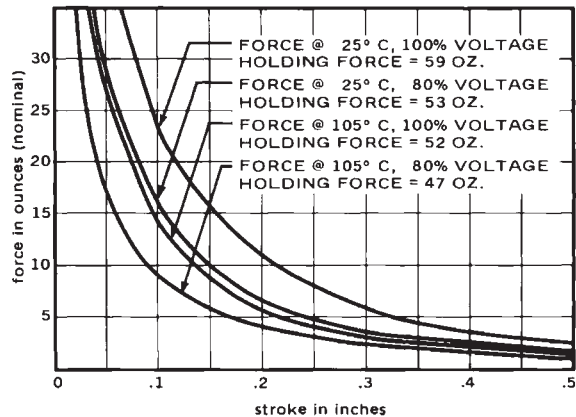

AC PULSE DUTY - 80VA

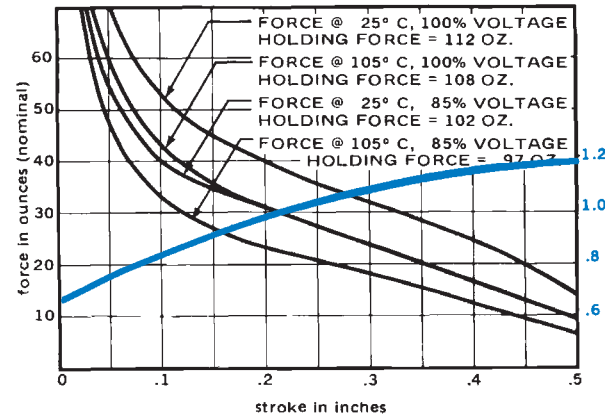

DC PULSE DUTY - 55 WATTS

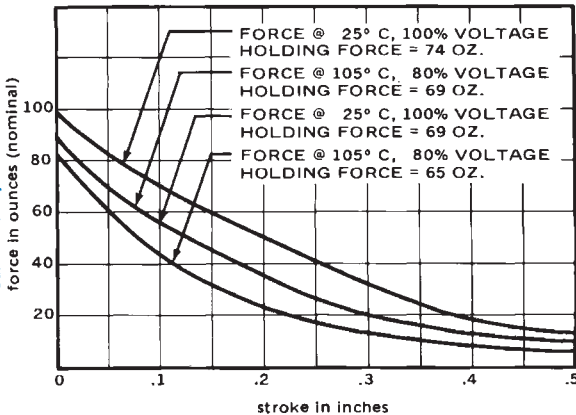

Standard intermittent duty cycle at nominal voltage is 25%, with 3 minutes maximum ON and 9 minutes minimum OFF in a repetitive cycle. Standard pulse duty cycle is 10% with 100 milliseconds ON and 900 milliseconds OFF.

Deltrol Controls, www.deltrol-controls.com
2740 S. 20th St. • Milwaukee, WI 53215 Phone (414) 671-6800 • Fax (414) 671-6809

| REV. | DESCRIPTION | DATE | BY | SCALE |
|------|-------------|------|----|-------|
| | | | | |
| | | | | |
| | | | | |
| | | | | |
| | | | | |
| | | | | |
| | | | | |



NAME
D-28 SOLENOID FORCE CURVES

| | | |
|-------------|--------------------------|------|
| DRAWING NO. | D-28 FORCE CURVES | REV. |
|-------------|--------------------------|------|